





RACK 2 IN

1				
2				
3				
4				
5				
6				
7				
8				
9				
10				
11				
12				
13				
14				
15				
16				
17	Horn 2	DPA 2011C	Small RB	Etage 3
18	Horn 1	DPA 2011C	Small RB	Etage 3
19	Tam Tam #2	DPA 2011C	Small RB	Etage 3
20	Congas x 2	DPA 2011C	Small RB	Etage 3
21				
22				
23				
24				
25	Trumpet 1	DPA 2011C	Small	Etage 2
26	Trumpet 3	DPA 2011C	Small	Etage 2
27	Trumpet 2	DPA 2011C	Small	Etage 2
28				
29				
30	Tbone 1	DPA 2011C	Small	Etage 2
31	Tbone 2	DPA 2011C	Small	Etage 2
32	Tuba	DPA 2011C	Tall LL	Etage 2
33	Vibraphone L	DPA 2011C	Tall	Etage 1
34	Vibraphone R	DPA 2011C	Tall	Etage 1
35	Keisu	DPA 2011C	Tall	Etage 1
36				
37	Piano Lo	DPA 2011C	Tall LL	Etage 1
38	Piano Hi	DPA 2011C	Tall LL	Etage 1
39				
40				
41	Gongs	DPA 2011C	Tall	Etage 1
42	Geisha Bell	DPA 2011C	Tall	Etage 1
43	Tam Tam #1	DPA 2011C	Small RB	Etage 1
44				
45				
46				
47				
48				
49				
50				
51				
52				
53				
54				
55				
56	Conductor Spy MICHAEL			

RACK 2 OUT

1	Brass monitor L
2	Brass monitor R
3	
4	
5	
6	
7	
8	
9	Sidefill L
10	
11	Sidefill R
12	
13	
14	
15	
16	Conductor
17	
18	
19	
20	
21	
22	
23	
24	TIMECODE

RACK 3 IN

1	
2	
3	
4	
5	
6	
7	Trombone 1
8	Trombone 2
9	Tuba
10	
11	
12	
13	
14	
15	
16	
17	
18	
19	
20	
21	
22	
23	
24	
25	
26	
27	
28	
29	
30	
31	
32	
33	
34	
35	
36	
37	
38	
39	
40	
41	
42	
43	
44	
45	
46	
47	
48	

RACK 3 out

1				
2				
3				
4				
5				
6				
7				
8				
9				
10				
11				
12				
13				
14				
15				
16				
17				
18				
19				
20				
21				
22				
23				
24				
25				
26				
27				
28				
29				
30				
31				
32				

v1 - Estimate based on the rehearsal (see picture bellow). Probably it will end up being more in a straight line, possible more rows since they play on Lucifer Stage

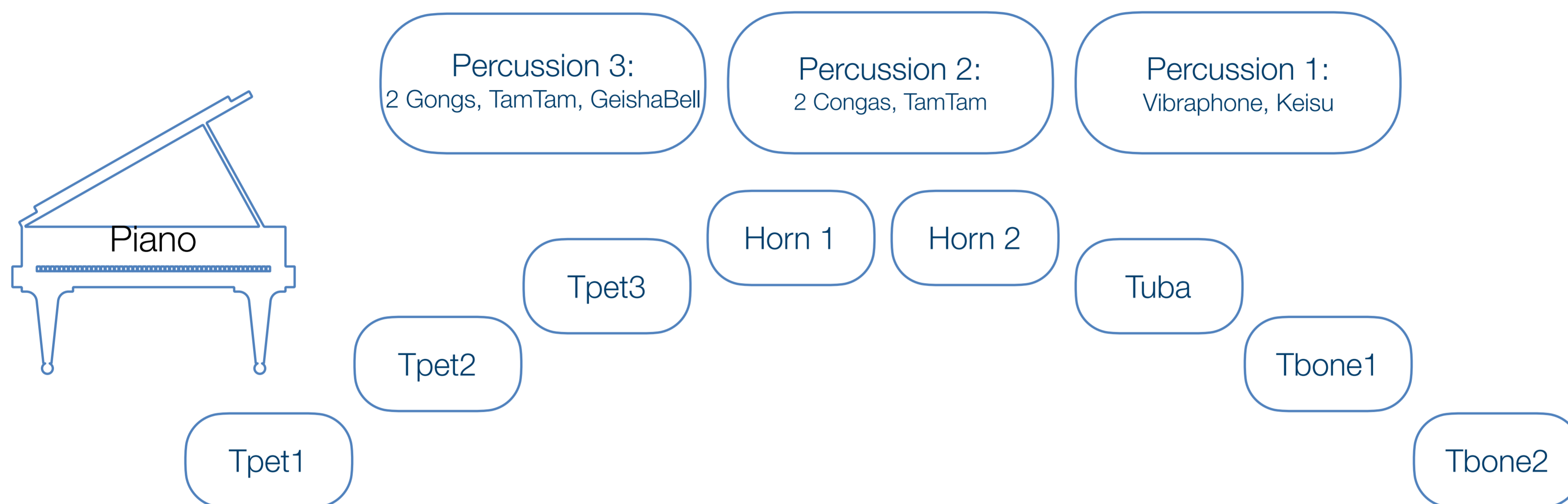

RACK 1 IN

1	Circle I	SM 58	
2	Circle II	SM 58	
3	Circle III	SM 58	
4	Circle IV	SM 58	
5	Circle V	SM 58	
6	Circle VI	SM 58	
7	Horn 1	CMC6 MK4	
8	Horn 2	CMC6 MK4	
9	Trumpet 1	CMC6 MK4	
10	Trumpet 2	CMC6 MK4	
11	Harmonium F	DI	
12	Piano L	CMC6 MK4	
13	Piano H	CMC6 MK4	
14	Ring Modulation	DI	
15			
16	Tuba Speech	SM 58	
17	Perc 1 Gong	CMC6 MK4	
18	Perc 1 Geisha	CMC6 MK4	
19	Perc 1 TamTam	CMC6 MK4	
20	Perc 3 TamTam	CMC6 MK4	
21	Perc 3 Conga	CMC6 MK4	
22	Perc 2 Vibra	CMC6 MK4	
23	Perc 2 Keisu	CMC6 MK4	
24	Perc 2 Toms	CMC6 MK4	
25	Harp	DPA 4099 C	
26	Vln 1	DPA 4099 V	
27	Vln 2	DPA 4099 V	
28	Vln 3	DPA 4099 V	
29	Vla 1	DPA 4099 V	
30	Vla 2	DPA 4099 V	
31	Oboe 1	CMC6 MK4	
32	Oboe 2	CMC6 MK4	
33	A-Flute 1	CMC6 MK4	
34	A-Flute 2	CMC6 MK4	
35	Bass Clarinet	CMC6 MK4	
36	Adjacent Room	CMC6 MK4	
37	Cello 1	DPA 4099 C	
38	Cello 2	DPA 4099 C	
39			
40			
41	Double Bass	DPA 4099 B	
42	Double Bass Pickup	Schertler DYN-B	
43	Bassoon	CMC6 MK4	
44	Counter Bassoon	CMC6 MK4	
45	Trombone speech mic	2x SM 58	On y-sum
46	Synthesizer/Organ	DI	REISE
47	Bassethorn FX mic	CMC6 MK4	Piano Clamp
48	Synthesizer/Organ	DI	JUGEND
49			
50			
51			
52			
53			
54			
55			
56	Conductor Spy MICHAEL		

RACK 1 OUT

1	<b>MON Bed</b>
2	
3	
4	
5	<b>MON Piano</b>
6	
7	
8	<b>MON Organ Backstage</b>
9	
10	<b>MON Table</b>
11	
12	
13	<b>MON L</b>
14	<b>MON C</b>
15	<b>MON R</b>
16	Conductor
17	Ring modulator
18	
19	
20	
21	
22	
23	
24	TIMECODE

RACK 3 IN

1	
2	
3	<b>Solo B-Horn 4061</b>
4	<b>Solo B-Horn 4099</b>
5	
6	
7	
8	
9	
10	<b>Solo Trumpet</b>
11	<b>Solo Trumpet SPARE</b>
12	<b>Tbone</b>
13	<b>Piano Lo</b>
14	<b>Piano Hi</b>
15	<b>Sopr</b>
16	<b>Ten</b>
17	<b>Bass</b>
18	<b>EVA dancer 1</b>
19	<b>LUZIFER dancer 2</b>
20	
21	
22	
23	
24	
25	
26	
27	
28	
29	
30	
31	
32	
33	
34	
35	
36	
37	
38	
39	
40	
41	
42	
43	
44	
45	
46	
47	
48	

RACK 3 out

1	In-Ear 1 Left	1 BP at Basset Horn player
2	In-Ear 1 Right	
3	In-Ear 2 Left	1BP at T-pet player
4	In-Ear 2 Right	
5	In-Ear 3 Left	1BP at T-Bone player
6	In-Ear 3 Right	
7	In-Ear 4 Left	
8	In-Ear 4 Right	
9	In-Ear 5 Left	
10	In-Ear 5 Right	
11	In-Ear 6 Left	
12	In-Ear 6 Right	
13		
14		
15		
16		
17		
18		
19		
20		
21		
22		
23		
24		
25		
26		
27		
28		
29		
30		
31		
32		

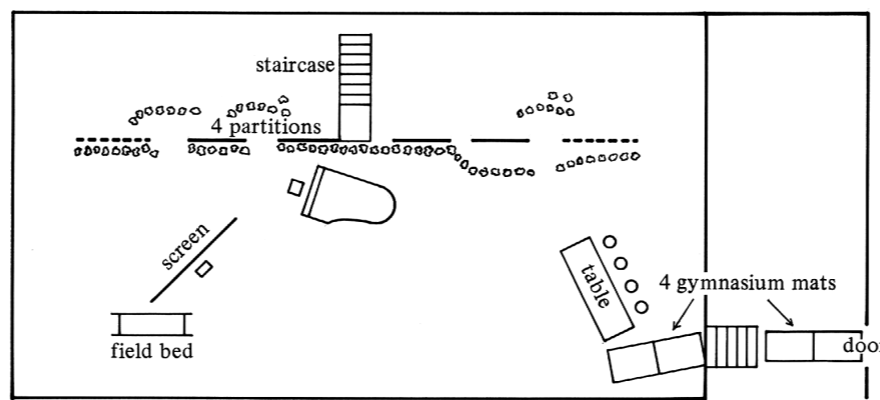
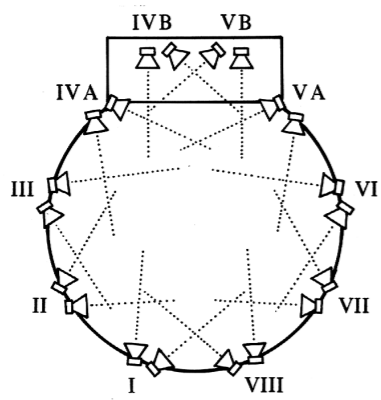
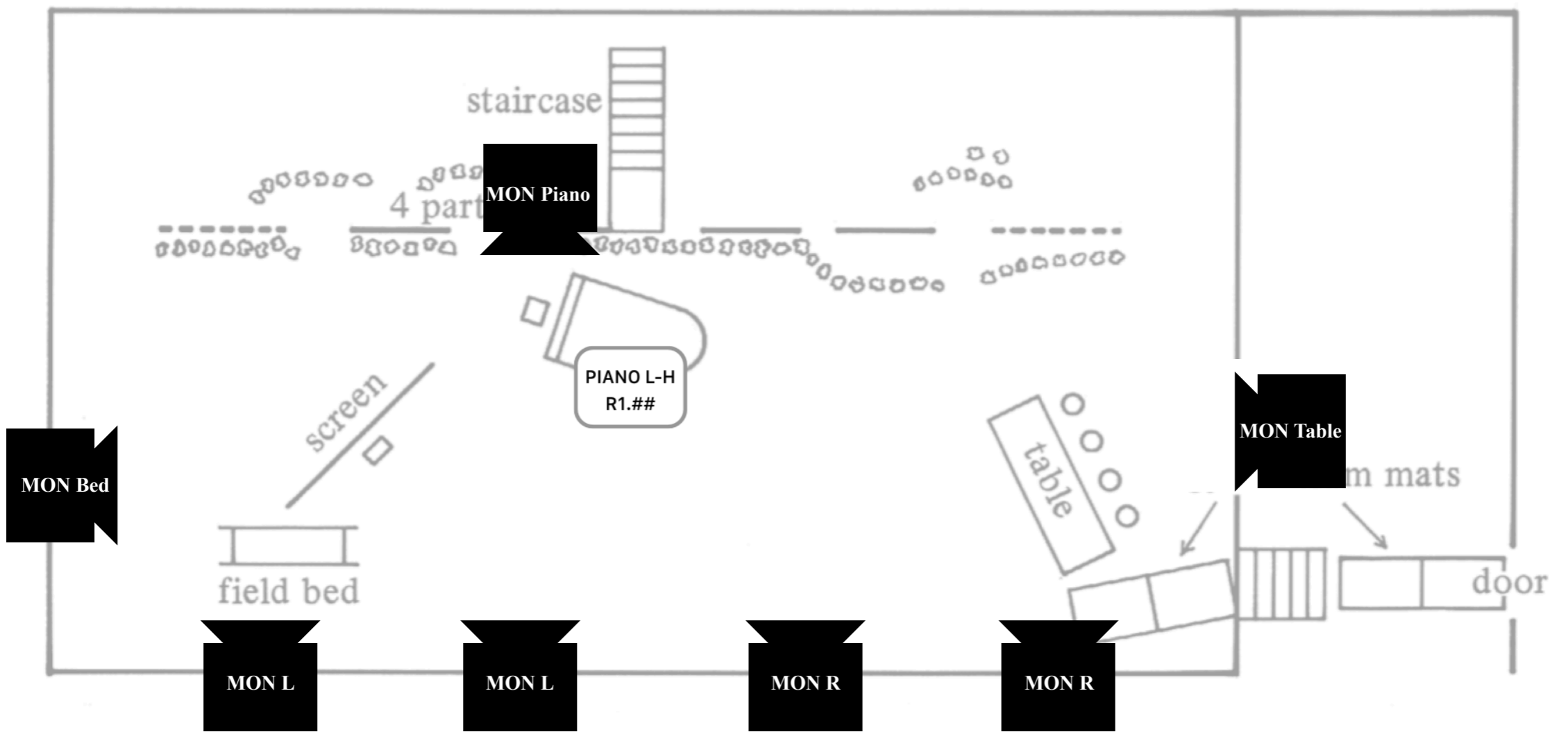
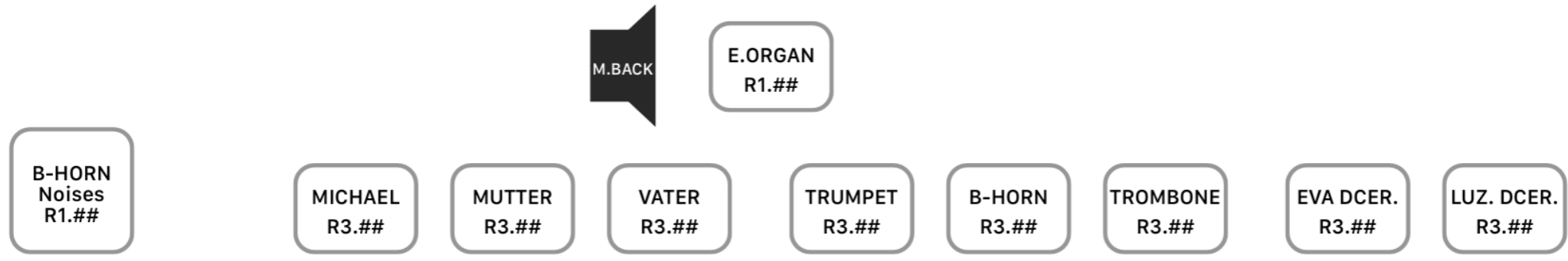

Distribution of Microphones in MICHAEL'S YOUTH for a quasi concert performance

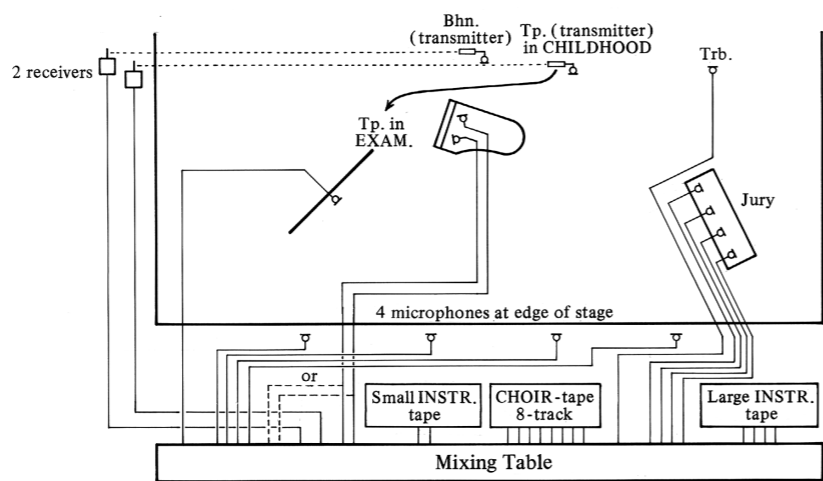

Mixing Table (Settings: La Scala 1981)

	LINE																																			
	1	2	3	4	5	6	7	8	9	10	11	12	13	14	15	16	17	18	19	20	21	22	23	24	25	26	27	28	29	30	31	32				
Ampl.																																				
Treble																																				
Bass																																				
Midrange filter																																				
Panorama																																				
HALL Channels																																				
Level																																				

At La Scala, the piano was on the left; for this reason the faders for piano, trumpet and basset-horn were rearranged.

## RACK 1 IN

Channel	Instrument	Mic	Stand	Note
1	Circle I	DPA 2011	Circle stand	
2	Circle II	DPA 2011	Circle stand	
3	Circle III	DPA 2011	Circle stand	
4	Circle IV	DPA 2011	Circle stand	
5	Circle V	DPA 2011	Circle stand	
6	Circle VI	DPA 2011	Circle stand	
7	Horn 1	CMC6 MK4	Small tripod + tape	
8	Horn 2	CMC6 MK4	Small tripod + tape	
9	Trumpet 1	CMC6 MK4	Small RB	
10	Trumpet 2	CMC6 MK4	Small RB	
11	Piano L	DPA 4099		
12	Piano H	DPA 4099		
13				
14	Ring Modulation	St DI		
15	Harmonium F	"		
16	Tuba Speech	SM 58	Tall LL	
17	Perc 1 Gong	CMC6 MK4	Tall	
18	Perc 1 Geisha	CMC6 MK4	Tall	
19	Perc 1 TamTam	CMC6 MK4	Choir Clamp metal version	
20	Perc 3 TamTam	CMC6 MK4	Choir Clamp metal version	
21	Perc 3 Conga	CMC6 MK4	Tall	
22	Perc 2 Vibra	CMC6 MK4	Tall	
23	Perc 2 Keisu	CMC6 MK4	RB + Boom	
24	Perc 2 Toms	CMC6 MK4	RB + Boom	
25	Harp	DPA 4099 B		
26	Vln 1	DPA 4099 V		
27	Vln 2	DPA 4099 V		
28	Vln 3	DPA 4099 V		
29	Vla 1	DPA 4099 V	Pre amp met clip en 4m xlr	
30	Vla 2	DPA 4099 V		
31	Oboe 1	CMC6 MK4	Small RB	
32	Oboe 2	CMC6 MK4	Small RB	
33	A-Flute 1	CMC6 MK4+Windshield	Tall	
34	A-Flute 2	CMC6 MK4+Windshield	Tall	
35	Bass Clarinet	CMC6 MK4	Small RB	
36	"HIMMEL"	CMC6 MK4	Tall	Behind screen upstage L
37	Cello 1	DPA 4099 C		
38	Cello 2	DPA 4099 C		
39				
40				
41	Double Bass	DPA 4099 B		
42	Double Bass Pickup	Schertler DYN-B		
43	Bassoon	CMC6 MK4	Small RB	
44	Counter Bassoon	CMC6 MK4	Small RB	
45	Trombone speech mic	2x SM 58	2x Tall LL + Y-Sum	
46	Synthesizer	DI	REISE	
47	BsstHorn FX Mic	MK4	JUGEND	
48	Synthesizer	DI	JUGEND	
49				
50				
51				
52				
53				
54				
55				
56	Conductor Spy MICHAEL	PTT mic		

## RACK 1 OUT

1	MON Tpet orchestra
2	MON Piano/Harmonium
3	
4	
5	MON Perc L
6	MON Perc C
7	MON Solo Tpet
8	Backstage orgel MJ
9	MON Synth/Org
10	MON Tbones
11	
12	
13	MON L
14	MON C
15	MON R
16	Conductor
17	Ring modulator
18	
19	
20	
21	
22	
23	
24	TIMECODE

## RACK 3 IN

1	Solo Trumpet
2	Solo Trumpet SPARE
3	Solo B-Horn
4	Solo B-Horn SPARE
5	1st Clarinet
6	2nd Clarinet / B-Horn
7	Trombone 1
8	Trombone 2
9	Tuba
10	
11	
12	
13	
14	
15	
16	
17	
18	
19	
20	Trombone 1 Voice
21	Trombone 2 Voice
22	
23	
24	
25	
26	
27	
28	
29	
30	
31	
32	
33	
34	
35	
36	
37	
38	
39	
40	
41	
42	
43	
44	
45	
46	
47	
48	

for quasi concert performances

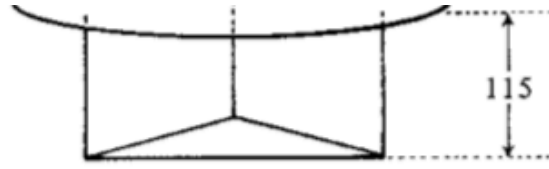

Staircase: 7 steps, each 16,5 high, 20 deep

All measurements are given in cm.

Orchestra Set-Up

